

APX



 BERETTA

APX

APX

PURPOSE-BUILT AS A DUTY GRADE FIREARM

The new Beretta APX striker-fired semiautomatic pistol, utilizing a removable, internal chassis, can be easily modified with replaceable grip frame housings and is simple to disassemble and maintain.

The extremely low profile, snag free, design of the APX makes it easy to carry and draw from the holster. To accommodate right or left-handed use, the magazine release button can be easily reversed.



Automatic striker block safety
Beretta APX pistols have a striker blocking device that prevents forward movement of the striker unless the trigger is completely pulled.



Striker Deactivation Button
Beretta APX pistols have a unique feature that allows the user to deactivate the internal striker mechanism prior to disassembly. This means the pistol can be field stripped without pulling the trigger.



Easy and quick disassembly
Thanks to the latch conveniently positioned on the side of the pistol.



3-Dot dovetail sights
Features a 3mm front dot for fast sight acquisition.

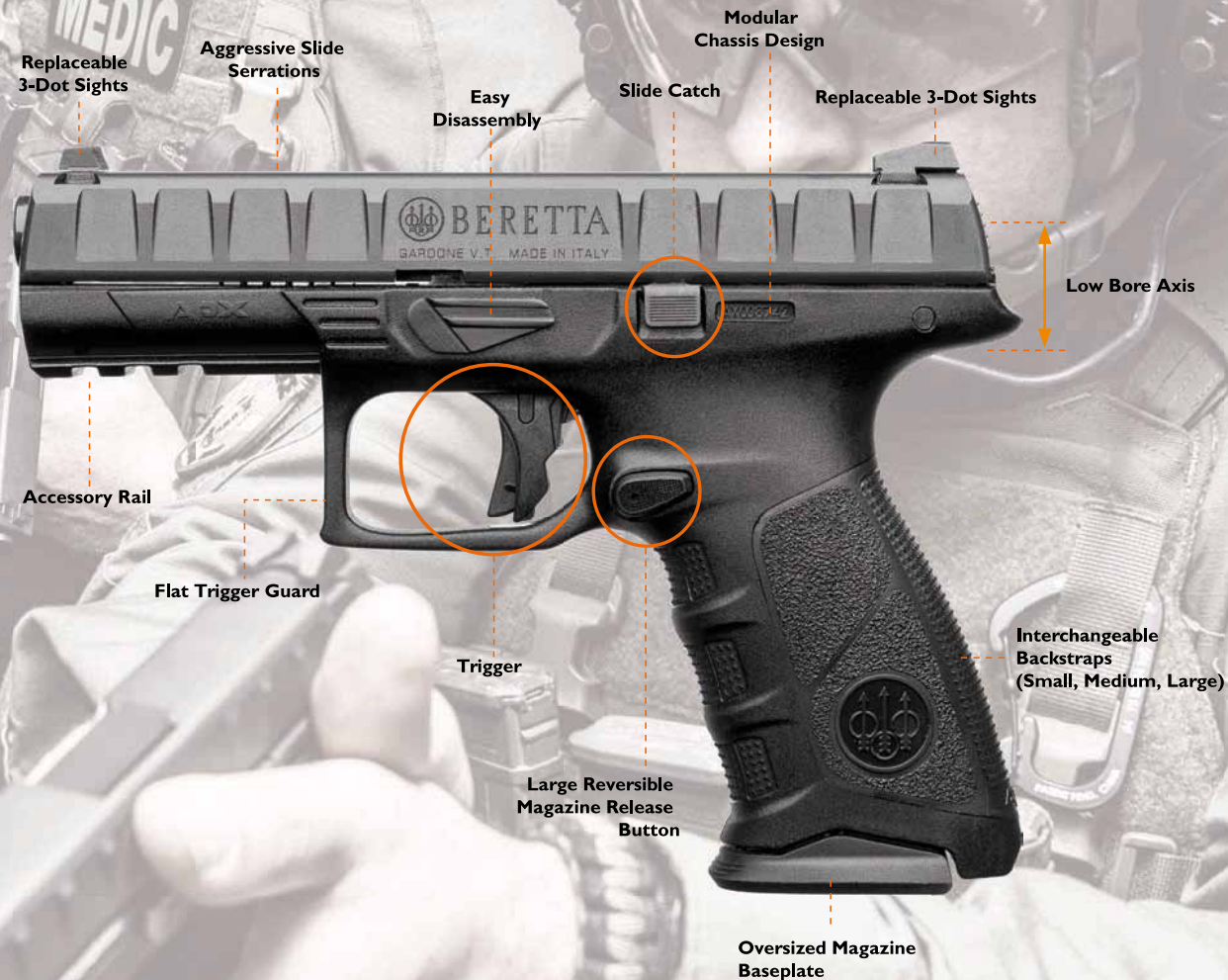

#WINTHEFIGHT

APX

RELIABILITY/DURABILITY

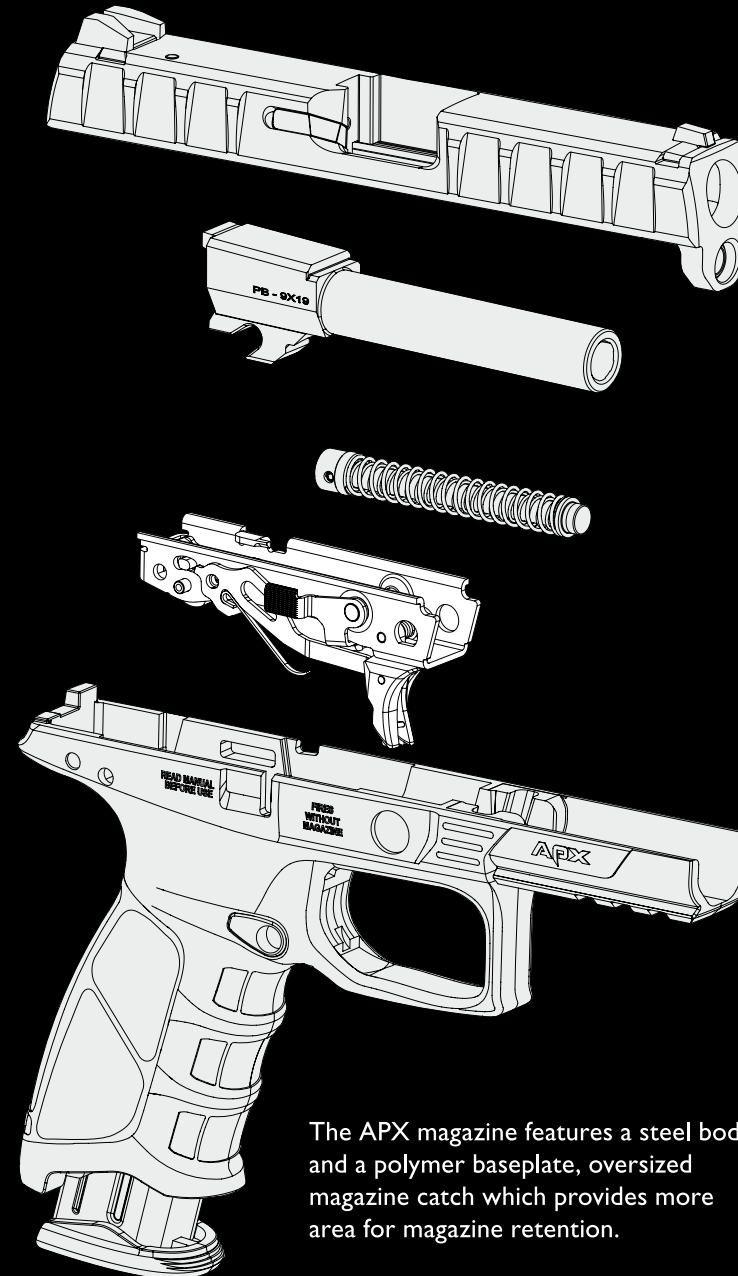

High-strength alloy steel



High-strength alloy steel slide with removeable dovetail sights, reliable steel extractor and integrated striker safety block. Aggressive slide serrations measure 11mm wide and 1.5 mm deep offering optimal grip surface area.

Cold-hammer forged



High-strength alloy steel, cold-hammer forged barrel with 1:10 rifling.

Helical recoil spring



Captive recoil spring features a helical design that lasts four times longer than a traditional recoil spring.

Serialized chassis



The serialized part of the gun is the high-strength stainless steel chassis that incorporates all of the mechanism, including the trigger and the slide stop.

Technopolymer design



The APX magazine features a steel body and a polymer baseplate, oversized magazine catch which provides more area for magazine retention.

BY THE NUMBERS

1,000,000+
Number of rounds fired during development.

500
Number of professional end-users surveyed during development.

45
Number of parts that make up the APX pistol.

4
Number of years APX was under development.

ERGONOMICS

Enhanced Grip Ergonomics

Through anthropometric studies and multiple rounds of user research, the ergonomics were optimized for a high grip position, controllability and easier sight tracking. This allows the gun to perform in the most adverse conditions.

Magazine Baseplate

Oversized magazine baseplate with corresponding relief cut in the frame and bevelled magazine well facilitate fast loading and extraction.



Slide Serrations

The sides of the slide offer snag-proof insertion and extraction of the pistol from its holster. The aggressive front and rear serrations on the distinctive slide facilitate slide operation and control in wet conditions.

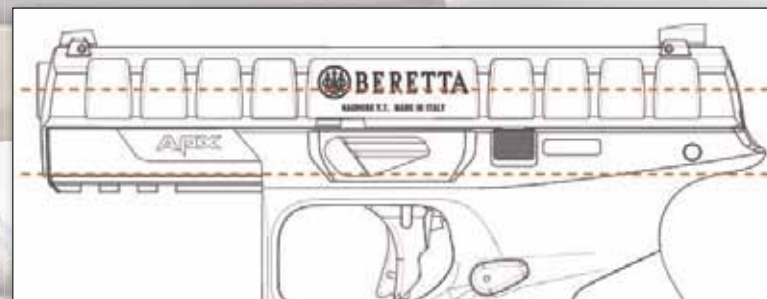

Low Bore Axis

The operational benefit of low felt recoil combined with controlling the gun and tracking the sights, especially under rapid fire strings, increases hit probability.

TRIGGER / CONTROLS

Trigger

Ergonomic, flat-faced design that promotes a straight rearward trigger press with minimal interruption of sight picture. 2.8 Kg trigger weight with clean break and 3mm tactile reset.

Trigger Guard

Larger trigger guard opening allows the user to shoot easily while wearing gloves. Flat front face provides optimal clearance for accessories.

Controls

Easy to operate controls are designed to accommodate from the 5th to 95th percentile of hand sizes. Allows smooth snag-free draws.



Ambidextrous/ Reversible Controls



Striker Deactivation Button

provides an additional level of safety by giving the user the option to deactivate the striker without pulling the trigger before disassembling the pistol.

APX

MODULARITY

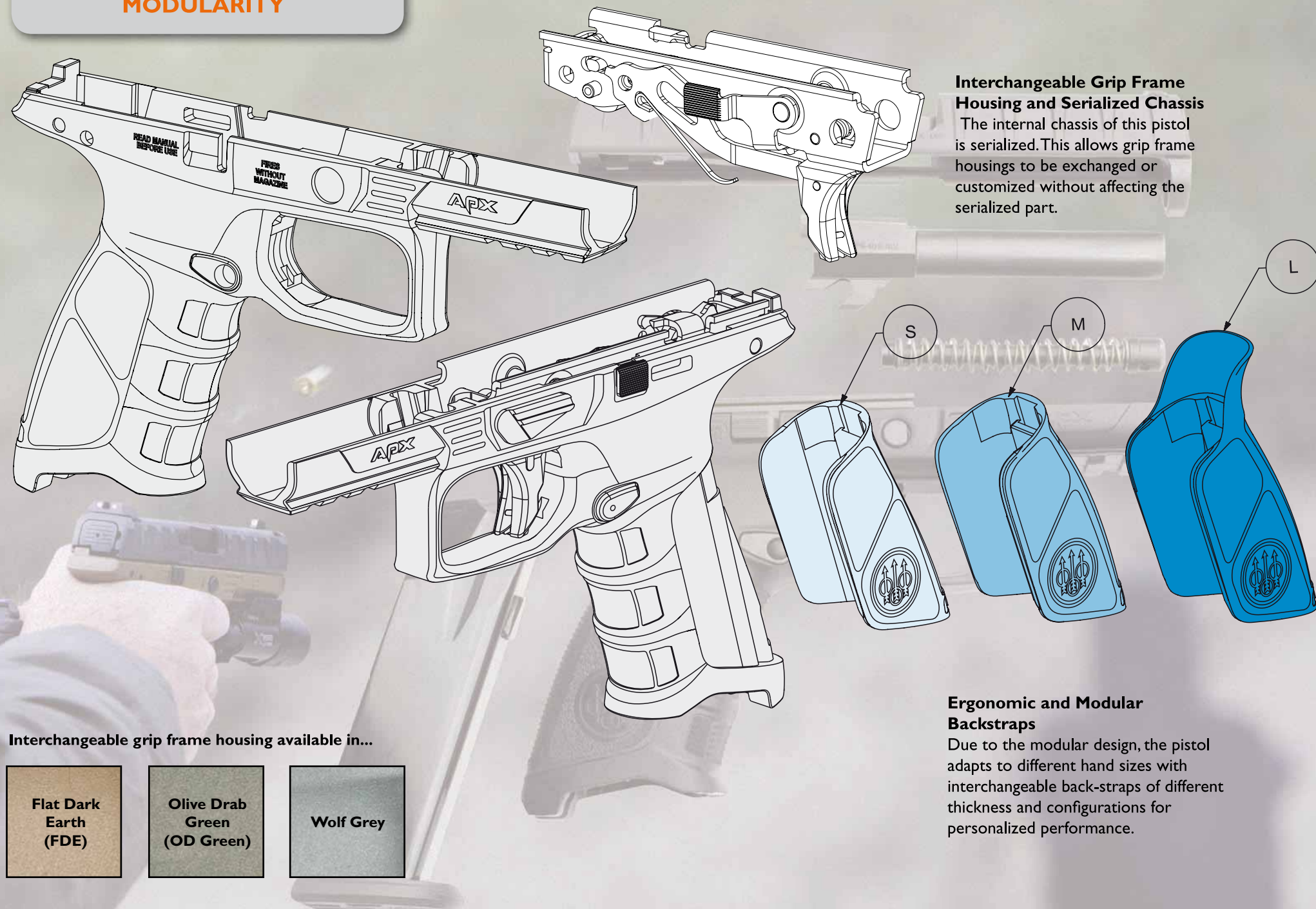

APX

APX ACCESSORIES

Visit www.BerettaUSA.com to see all available APX accessories

Frames



Training Aids



Sights



Magazines



Coming Soon

Beretta will continue to release new accessories for the APX.

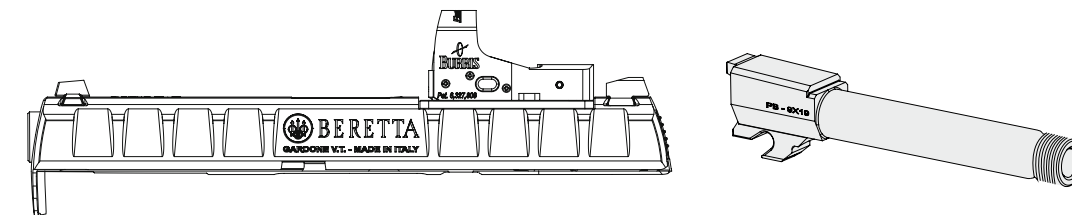

APX HOLSTERS



APX MODEL H
SHOULDER HOLSTER
E01788 RH

SHOULDER



APX COMP MOD
ULTIMATE HOLSTER
E01207 RH • E01208 LH



APX MODEL 5
LEATHER HOLSTER
E01786 RH



APX MODEL 2
LEATHER HOLSTER
E01789 RH



APX COMP MOD
STINGER HOLSTER
E01209 RH • E01210 LH



APX CIVILAN HI-LO RIDE
HOLSTER
E01205 RH



APX MODEL 4
LEATHER HIP HOLSTER
E01785 RH

OWB



APX MOD S HOLSTER
E01213 RH



APX MODEL I
LEATHER HOLSTER
E01787 RH



APX HYBRID HOLSTER
E01212 RH

IWB



PARTS / DATA

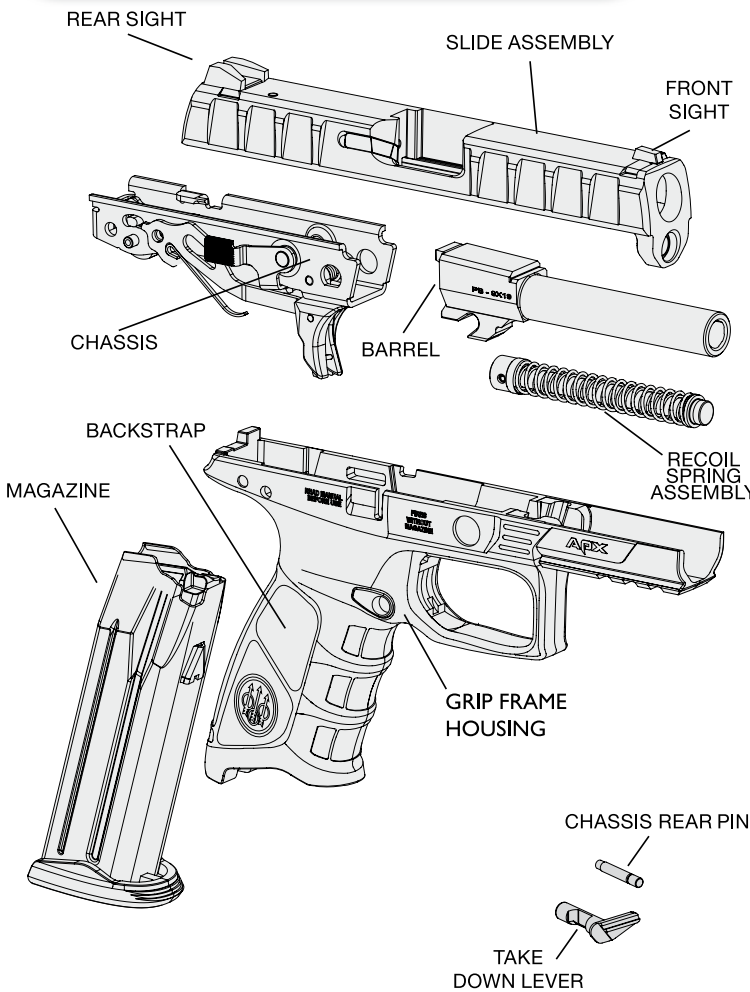

EACH PISTOL COMES WITH:

- Instruction manual
- Cable lock
- Spare magazines
- Magazine loader
- 3 backstraps
- Cleaning rod and brush kit
- Storage case

Model	APX	APX
Caliber	9x19mm	.40 S&W
Magazine	17 rounds	15 rounds
Rifling Pitch	250 mm / 10 in	400 mm / 16 in
Rifling	R.H. - 6 grooves	R.H. - 6 grooves
General Operation	Semiautomatic, short recoil system	Semiautomatic, short recoil system
Locking System	Tilt-barrel, locked breech	Tilt-barrel, locked breech
Sights	Removable front and rear sights	Removable front and rear sights
Chassis	Stainless steel	Stainless steel
Grip frame housing	Fiberglass reinforced technopolymer	Fiberglass reinforced technopolymer
Slide	Steel with black Nitride finishing	Steel with black Nitride finishing
Barrel	Steel with black Nitride finishing	Steel with black Nitride finishing
Action	Striker fired	Striker fired
Safeties	Striker deactivation button, firing pin block safety, trigger safety.	Striker deactivation button, firing pin block safety, trigger safety.
Overall length	192 mm / 7.56 in	192 mm / 7.56 in
Barrel length	108 mm / 4.25 in	108 mm / 4.25 in
Overall width	33 mm / 1.30 in	33 mm / 1.30 in
Grip width	33 mm / 1.30 in	33 mm / 1.30 in
Overall height	142 mm / 5.60 in	142 mm / 5.60 in
Sight radius	160 mm / 6.30 in	160 mm / 6.30 in
Approximate weight unloaded	780 grams / 27oz	780 grams / 27oz



APX



FABBRICA D'ARMI PIETRO BERETTA S.p.A
Via P. Beretta, 18 - CP 160
Tel +39 030 83411
25063 Gardone Val Trompia, Brescia ITALY

BERETTA.COM
BERETTADEFENSETECHNOLOGIES.COM

ENG

07/2017